



**30**  
kN

**60**  $\varnothing$ 25  
mm

**R**  
3/8"  
BSP

**R**  
250  
bar

**GO/GC**  
3/8"  
BSP

**GO**  
200  
bar

**GC**  
300  
bar

**15**  
kN

**900**  
nm

**21**  
kg

**20**  
l/min

Hydraulic rotator FHR 3.000L is cost-effective solution generally for seasonal use in forestry, agriculture, general cargo and material handling.

Rotator's upper mount is applied in EYE form factor of the knuckle joint. Robust and tough built to withstand even overloads. The wide of eye is common standard width 60mm and the knuckle pin diameter 25mm.



FHL 01-A/B-60/25



FHL 01B-A/B-60/25

Rotator lower mount is applied in AXLE form factor to mount in grapple / tool mounting tube or adaptor and by fixing with pin. Axle (shaft) diameter is 49.5mm and the fixing pin (not included) diameter 30mm

**49.5**  $\varnothing$ 30  
mm

**GO/GC**  
3/8"  
BSP

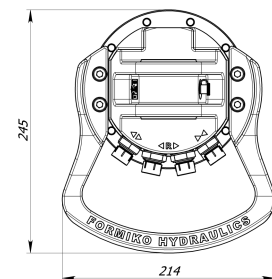
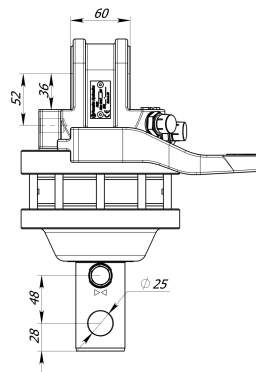
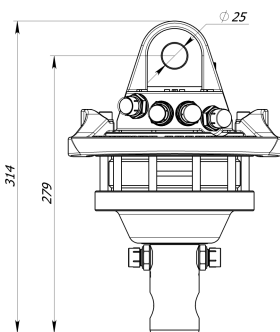

For additional information relating to price levels and technical data, please contact [sales@formiko.lv](mailto:sales@formiko.lv)

**Formiko Hydraulic s Ltd**

Dzircema Str. 119 k-1,  
Riga LV1055 LATVIA

+371 294 49 552  
+371 264 59 383  
[sales@formiko.lv](mailto:sales@formiko.lv)  
[www.formiko.lv](http://www.formiko.lv)

On request by special conditions there are metric nipples available for rotator FHR 3.000L



FORESTRY GENERAL CARGO AGRICULTURE





Hydraulic rotator FHR 3.000L is cost-effective solution generally for seasonal use in forestry, agriculture, general cargo and material handling.



Rotator's upper mount is applied in EYE form factor of the knuckle joint. Robust and tough built to withstand even overloads. The wide of eye is common standard width 60mm and the knuckle pin diameter 25mm.



Rotator lower mount is applied in AXLE form factor to mount in grapple / tool mounting tube or adaptor and by fixing with pin. Axle (shaft) diameter is 49.5mm and the fixing pin (not included) diameter 30mm



Rotator FHR 3.000L based on reliable vane type hydraulic motor which delivers torque up to 900Nm at 25MPa.



Formoko rotator FHR 3.000L is compatible with FHL 01-A/B-60/25 and FHL 01B-A/B-60/25 series links.



Rotator for shipping is packed in compact solid cardboard box with dimensions 340x230x240mm.



We providing TWO year warranty for this rotator.

For additional information relating to price levels and technical data, please contact [sales@formiko.lv](mailto:sales@formiko.lv)

**Formiko Hydraulic s Ltd**

Dzirnieka Str. 119 k-1,  
Rīga LV1055 LATVIA

+371 294 49 552

+371 264 59 383

[sales@formiko.lv](mailto:sales@formiko.lv)

[www.formiko.lv](http://www.formiko.lv)

On request by special conditions there are metric nipples available for rotator FHR 3.000L

FORESTRY GENERAL CARGO AGRICULTURE

